

QDI3030B

High Power, High Isolation

Features:

- * High Power
- * High Isolation
- * Low Insertion Loss
- * Low VSWR

Applications:

- * Wireless
- * Radar
- * Laboratory Test

Description

QDI3030B series Drop-In Isolators cover frequency range 2~6GHz. High power, high isolation and low insertion loss make it ideal for a lot of applications like amplifiers, transceivers, etc.

Specifications

Frequency (MHz)	Bandwidth (MHz)	Insertion Loss (dB Max.)	Isolation (dB Min.)	VSWR (Max.)	Average Power (W)	Temperature (°C)
2000~6000	4000	1.7	12	1.6	20	-40~+70

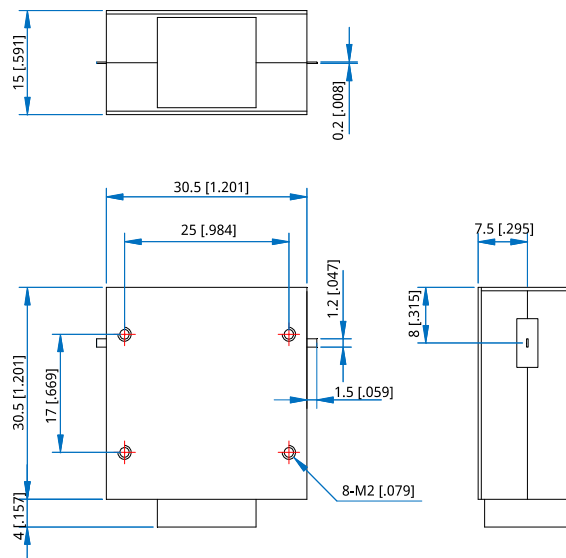
Outline Drawings

Unit: mm [inch] Tolerance: $\pm 0.2\text{mm}$ [$\pm 0.008\text{in}$]

Mechanical

Size*1:	30.5*30.5*15mm 1.201*1.201*0.591in
Connector Type:	Strip line
Mounting:	8-M2mm deep 4 mm

[1] Exclude connectors

Direction Naming Rules:

- 1 - Clockwise
- 2 - Anticlockwise

How To Order
QDI3030B-V-W-X-Y-Z

- V: Start frequency in MHz
- W: Stop frequency in MHz
- X: Forward Power in W
- Y: Reverse Power in W
- Z: Direction type

Examples:

To order a QDI3030B series Isolator, 2~6GHz , Forward power 20W, Reverse power 20W, Clockwise, specify

QDI3030B-2000-6000-20-20-1.

Customization is available upon request.